



---

## To use Palette ver.5 on Windows Vista, Windows 7, 8, or 10

---

Palette Ver.5.61 is compatible with 32bit processors ONLY.  
Palette Ver.5.61 is not usable on computers with a 64bit processor.

### <<NOTE>>

You cannot successfully install the program from the original CD in your package!!

Please follow the procedure below to install the **Driver** and **Software program**.

- Step 1:** Download the programs
- Step 2:** Install the Driver for your card writer
- Step 3:** Install the Software program
- Step 4:** Set up the "Compatibility mode"

### Step 1: Download the programs

1. **The Driver for Card Writer: setupCRWDriver301PAL.exe (3.26 MB)**
2. **The Software Program: pal561Fullset\_Eng.exe (18.2 MB)**

### Step 2: Install the Driver for your card writer

1. Double-click on the downloaded "setupCRWDriver301PAL.exe" file. The update process will automatically start.
2. Follow the instructions and proceed through the installation process.

### Step 3: Install the Software program

1. Double-click on the downloaded "pal561Fullset\_Eng.exe" file. The update process will automatically start.
2. Follow the instructions and proceed through the installation process.



#### Step 4: Set up the “Compatibility mode”

1. Select “Start”→”All Programs”→ “Palette Ver.5”, and right-click on “Design Center”. Then click the “Properties” displayed in the Menu.
2. When “Property” dialogue appears, click on “Compatibility” tab and click the key ”Show setting for all users”.
3. “Embmake Properties” dialogue will appear. On “Compatibility mode”, please set up as follows:
  - Check on “Run this program in compatibility mode for:”.
  - Select “Windows XP(Service Pack 2)” in the combo box under the check box.

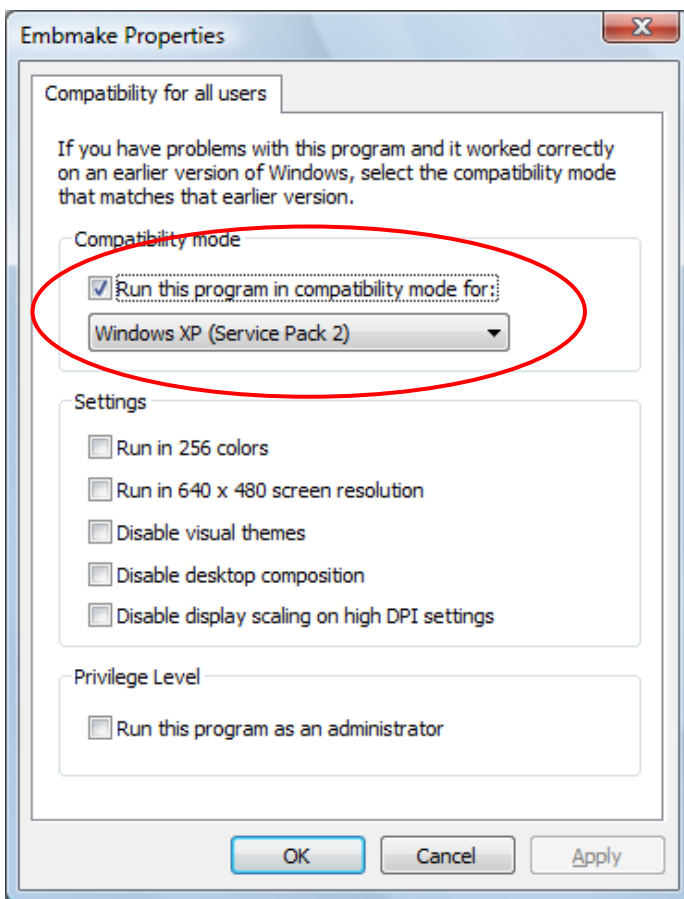

4. Click on OK, close the dialogue of “Embmake Properties” and “Property”.
5. As for “Layout & Editing” (Start→All Programs→Palette Ver.5), please set up in the same way as above.

