



# LEARN & CREATE

with Baby Lock

## Sugar Skull Embroidered Bomber Jacket



Embroidery gets a little edgy with this embroidered skull bomber jacket! This fashion-forward piece of outerwear is great for fall, particularly any Halloween or Day of the Dead celebrations! With the Solaris' perfect positioning capabilities, your designs will be centered and flawless with virtually no effort on your part.

**Skill Level: Beginner**

Created by: Diane Kron

### Supplies:

Baby Lock® Solaris Sewing and Embroidery Machine

9 ½" x 9 ½" Embroidery hoop

Purchased silk bomber jacket

Madeira® embroidery thread

Baby Lock Fusible Tear-Away Firm Stabilizer (BLT105)

Basic sewing and embroidery supplies

## Instructions:

### Embroidery:

- 1) Using a seam ripper, remove the stitches from the jacket's inside lining on the side and sleeve seams. This will make it easier to embroider the jacket's outer layer.
- 2) Hoop the Baby Lock Fusible Tear-Away Firm Stabilizer with the shiny side up. Remove the shiny side of the paper from the stabilizer. Using a pin, gently score the paper close to the edge inside the hoop. Peel away this top layer to reveal the sticky side of the stabilizer.
- 3) Determine the center on the jacket back. Place a Positioning Sticker at that point.
- 4) Place the stickered jacket centered in the hoop. Finger press to secure to the stabilizer.
- 5) Set up the machine for embroidery.
  - a) Wind two bobbins using the Finishing Touch Thread that comes packaged with the machine. This bobbin thread is the perfect thread for the job. The machine is calibrated for this thread thickness and should always be used to achieve the best results.
- 6) Place the hoop onto the embroidery unit.
- 7) To retrieve the design, follow the next set of steps:
  - a) Click on the Embroider option on the opening screen.



- b) Select Exclusives.
- c) Select the Novelty category.
- d) Then select design 004 (as shown on the illustration below).

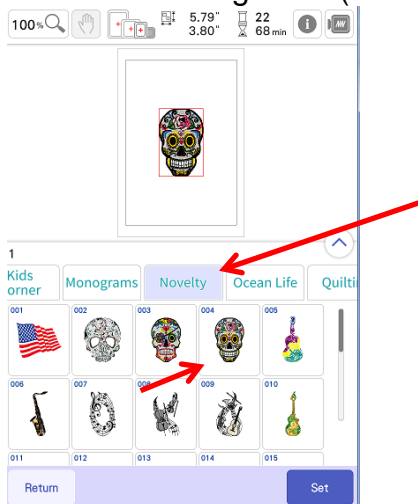

- e) Click on Set to place the design on the workspace.

- 8) With this design, we will use the Size Editing tool. Follow the next set of steps to resize the design larger:
  - a) Click on Edit.
  - b) Select Size from the Edit field.
  - c) In this field, click on the second sizing option (as shown in the following illustration). This option will resize the design while maintaining the stitch density.
  - d) When the following message appears on the screen, click OK.

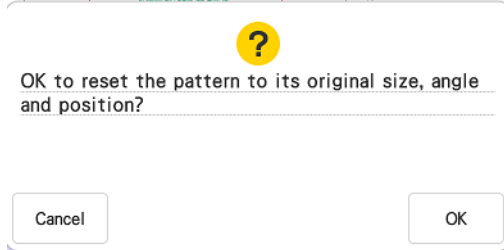

- e) In the next field, click on the arrows pointing outward to resize the design to its largest possible size that will fit inside the 9 1/2" x 9 1/2" hoop. (Refer to the illustration below for that size.) Another way to resize the design is by using your index finger and thumb to touch the screen and go outward with the two digits to resize the design larger. The finished size is approximately 6.38" x 4.18". Please note that the machine has been set up to use inches. To set up the machine in inches, click on the properties field and go to Page 9. Click on the arrow next to Unit to change to inches (as shown below in the 2<sup>nd</sup> illustration).

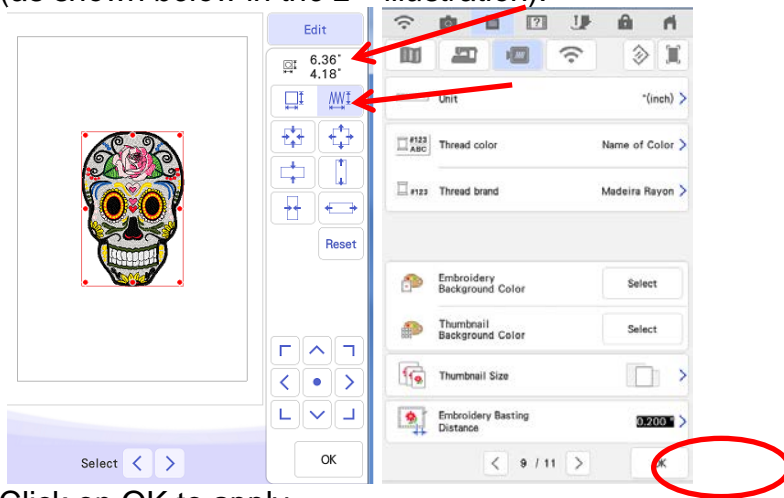

- f) Click on OK to apply.
- 9) To edit the thread colors on the design, click on the Thread Color Chip option (as shown below) and follow the next set of steps:

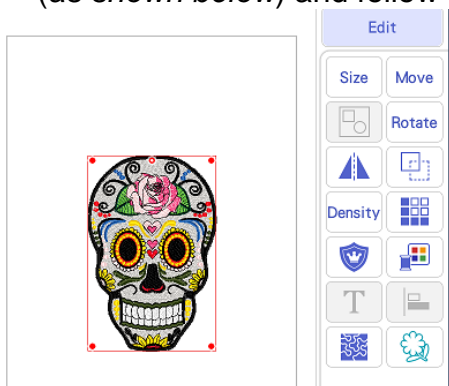

- a) Select the Madeira Poly thread catalog. Use the arrow next to the thread catalog to page through the thread catalogs. Since we will be wearing the jacket outside, we want the design to withstand fading. Madeira Polyester thread is the perfect choice.

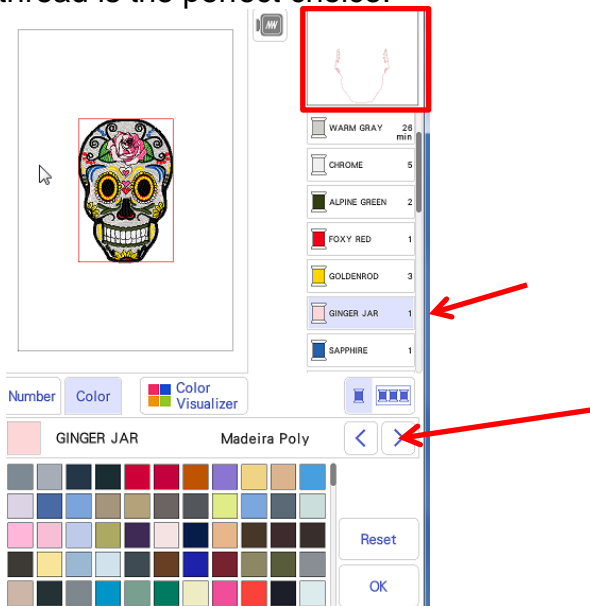

- b) To change certain colors in the image, use the scroll bar on the right side of the color options scroll down and select the first light pink thread from the list.
  - c) Change this color to a dark pink. **Note:** the selected area will be displayed in the window pane on the top right side of the window.
  - d) Scroll down and select the next light pink and the dark pink color that was used prior. Repeat until all of the light pink colors have been changed to the same dark pink color. **Note:** The color changes have been applied to the design.
- 10) The design is almost ready to be stitched. Place the hoop on the embroidery unit.
- a) Click on OK.
  - b) Click on Embroidery.
  - c) Click on Layout.
  - d) Select the Positioning Sticker icon. The machine will scan the area inside the hoop and position the design.
  - e) Thread the machine with the first color thread that is listed in the design.
  - f) Click on the Start button on the machine to embroider the first color.
  - g) Repeat for the other colors on the design, until all of the colors have been embroidered.
  - h) Gently, remove the stabilizer from the backside of the jacket.

### Sewing:

- 1) Set up the machine for sewing.
- 2) Select a straight stitch.
- 3) Place the "J" foot on the machine.
- 4) Thread the machine with a thread color that matches the lining material.
- 5) Sew up the side seam and the seam on the sleeve.

For other exciting projects like this one, visit Baby Lock at [www.babylock.com](http://www.babylock.com).

©2018 Baby Lock USA. This project may be freely used by individuals for non-commercial purposes. Project instructions may not be sold or distributed without approval from Baby Lock. Baby Lock must be acknowledged as the source of the project instructions through copyright or online link