

# BABY LOCK SEWING ACCESSORIES

## General Purpose Zig Zag Foot

(BLG-ZZ)

### Instructions

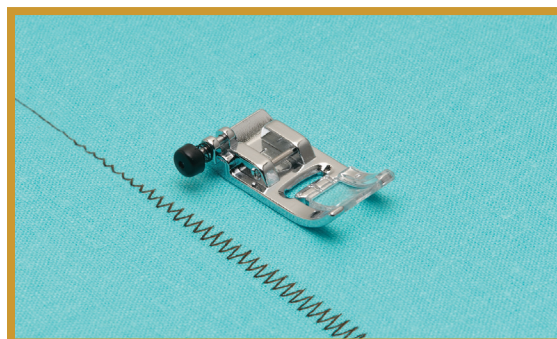

This presser foot is perfect for utility stitches and other standard functions. This is a great accessory to have on-hand if your machine's original foot is misplaced.

#### INSTRUCTIONS:

1. Press the "Needle Position" button to raise the needle.
2. Press . The entire screen becomes white, and all keys and operation buttons are locked.
3. Raise the presser foot lever.
4. Press the black button on the presser foot holder and remove the presser foot.

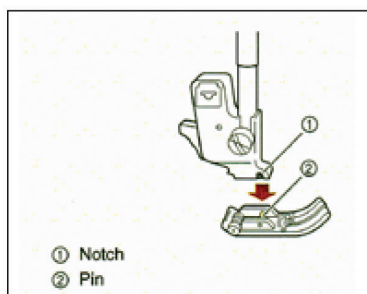
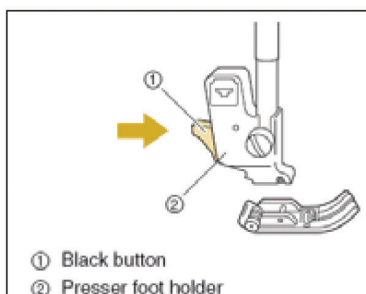

5. Place the new presser foot under the holder, aligning the foot pin with the notch in the holder. Lower the presser foot lever so that the presser foot pin snaps into the notch in the holder.

#### Using the "Presser Foot Lifter" button:

The sewing machine can sew fabrics up to 6 mm (approx. 1/4 inch) thick. If the thickness of a seam causes sewing to occur at an angle, help guide the fabric by hand and sew on the downward slope.

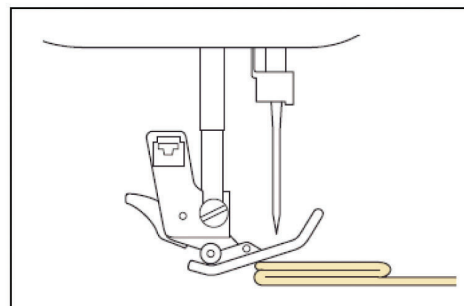

If the presser foot is in the up position, and you are sewing heavyweight or multiple layers of fabric which do not fit easily under the presser foot, use the presser foot lever to raise the presser foot to its highest position. The fabric will now fit under the presser foot.

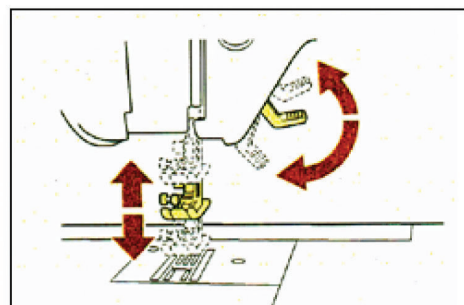

**baby lock**

**FOR THE LOVE OF SEWING**

If the fabric does not feed when starting to sew or when sewing thick seams, press the black button on the left side of presser foot "J".

1. Raise the presser foot.
2. While keeping the black button on the left side of presser foot "J" pressed in, lower the presser foot.

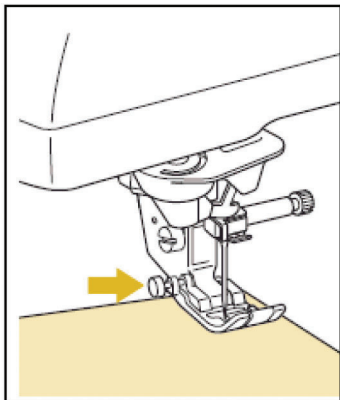

3. Release the black button. The presser foot remains level, enabling the fabric to be fed.

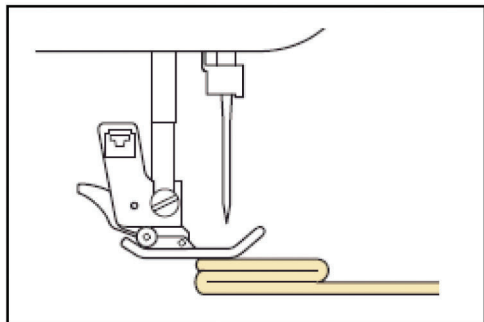

**Note:** Once the trouble spot has been passed, the foot will return to its normal position. When "Automatic Fabric Sensor System" (Automatic Presser Foot Pressure) in the machine settings screen is set to "ON", the thickness of the fabric is automatically detected by the internal sensor so the fabric can be fed smoothly for best sewing results.



**FOR THE LOVE OF SEWING**