

BABY LOCK SEWING ACCESSORIES

Zipper Foot

(BLG-WZF)

Instructions

This is the best sewing foot for inserting zippers, snap tape, and more. Adjust the foot to either the right or left to sew both sides of your zipper easily. You can also use it to attach piping or decorative cording.

INSTRUCTIONS: Centered Zipper

Centered Zipper is the most common application and is often used for bags and other applications where some part of the zipper is visible.

1. Select .

Note: Make sure you sew using the middle needle position.

2. Attach the all-purpose presser foot and sew straight stitches up to the zipper opening. Change to a basting stitch (or longest stitch length setting) and sew to the top of the fabric.

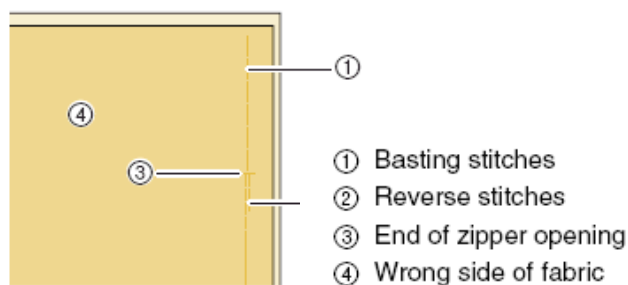

3. Press the seam allowance open and attach the zipper with a basting stitch in the middle of each side of the zipper tape.

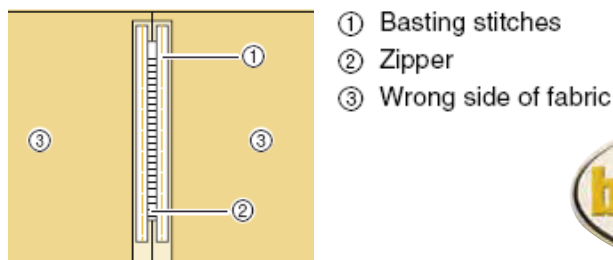

4. Remove the presser foot. Align the right side of the pin in zipper foot with the presser foot holder, and attach the zipper foot.

- ① Right
- ② Left
- ③ Needle drop position

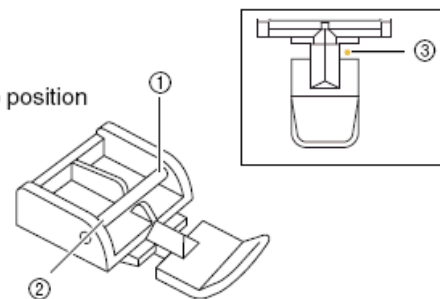

5. Topstitch 7 to 10 mm (approx. 1/4 to 3/8 inch) from the seamed edge of the fabric, then remove the basting.

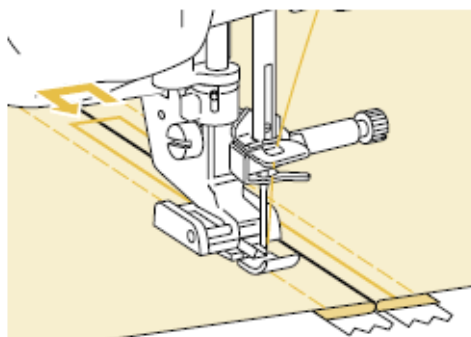

FOR THE LOVE OF SEWING

INSTRUCTIONS: Side or Lapped Zipper

Side or Lapped Zipper is the most commonly used for skirts and dress applications where the zipper is covered by a fold of the fabric and is not visible.

1. Follow steps one and two from above Centered Zipper Instructions.

2. Press the seam allowance open and align the folded hem along the teeth of the zipper, while maintaining 3 mm (approx. 1/8 inch) of sewing space.

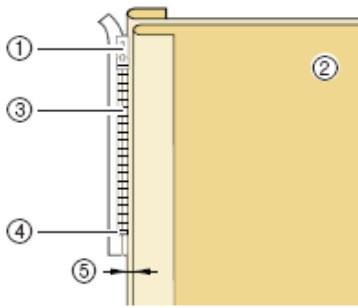

- ① Zipper pull tab
- ② Wrong side of fabric
- ③ Zipper teeth
- ④ End of zipper opening
- ⑤ 3 mm (approx. 1/8 inch)

3. Remove the all-purpose presser foot.

4. Align the right side of the pin in Zipper Foot with the presser foot holder, and attach the presser foot. Make sure you sew using the middle needle position.

5. Set the presser foot in the 3 mm (approx. 1/8 inch) margin.

6. Starting from the end of the zipper opening, sew to a point about 50 mm (approx. 2 inches) from the edge of the fabric, then stop the machine.

7. Pull down the zipper slider, then continue sewing to the edge of the fabric.

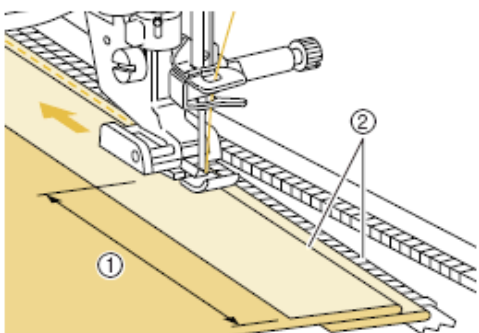

- ① 50 mm (approx. 2 inches)
- ② 3 mm (approx. 1/8 inch)

8. Close the zipper, turn the fabric over, and sew a basting stitch.

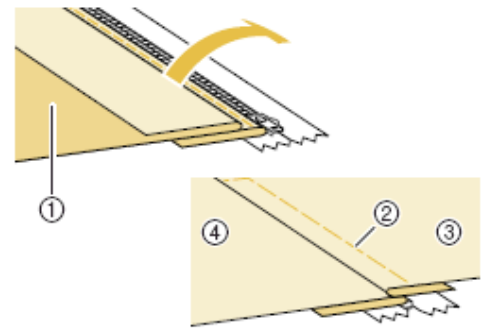

- ① Front of the skirt (wrong side of fabric)
- ② Basting stitches
- ③ Front of the skirt (right side of fabric)
- ④ Back of the skirt (right side of fabric)

9. Remove the presser foot, and reattach it so that the left side of the pin is attached to the presser foot holder.

Note: When sewing the left side of the zipper, the needle should drop on the right side of the presser foot. When sewing the right side of the zipper, the needle should drop on the left side of the presser foot.

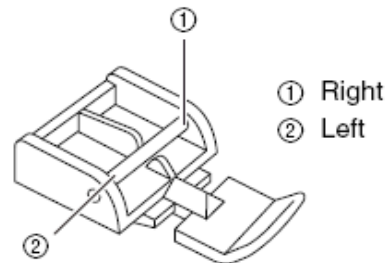

10. Set the fabric so the left edge of the presser foot touches the edge of the zipper teeth.

11. Sew reverse stitches at the top of the zipper, then continue sewing.

12. Stop sewing about 50 mm (approx. 2 inches) from the edge of the fabric, leave the needle in the fabric, and remove the basting stitches.

13. Open the zipper and sew the rest of the seam.



FOR THE LOVE OF SEWING

800-422-2952

www.babylock.com